

3角記號凸出0.03

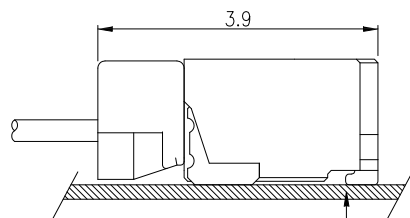

MATED CONDITION

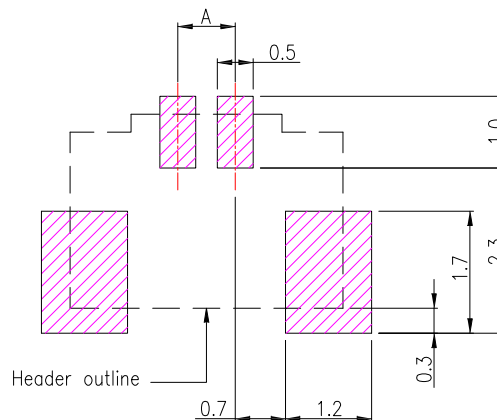

P.C.B LAYOUT MOUNTING PATTERN

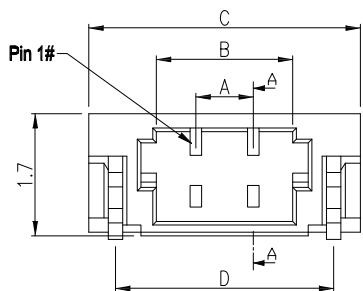

Pin 1#

1.7

2.70

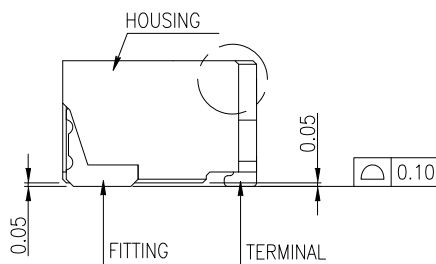

0.05

0.10

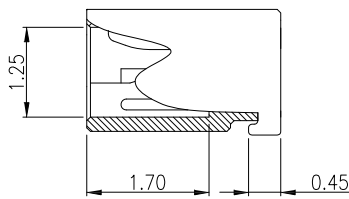
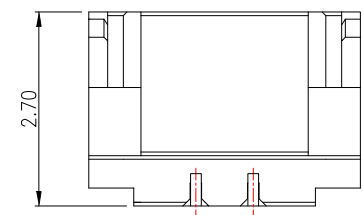

SECTION A-A

PIN NO.	D1MA	D1MB	D1MC	D1MD
2	0.80	1.90	3.78	3.04
3	1.60	2.70	4.58	3.84
4	2.40	3.50	5.38	4.64
5	3.20	4.30	6.18	5.44
6	4.00	5.10	6.98	6.24
7	4.80	5.90	7.78	7.04
8	5.60	6.70	8.58	7.84
9	6.40	7.50	9.38	8.64
10	7.20	8.30	10.18	9.44
11	8.00	9.10	10.98	10.24
12	8.80	9.90	11.78	11.04
13	9.60	10.70	12.58	11.84
14	10.40	11.50	13.38	12.64
15	11.20	12.30	14.18	13.44
16	12.00	13.10	14.98	14.24
17	12.80	13.90	15.78	15.04
18	13.60	14.70	16.58	15.84
19	14.40	15.50	17.38	16.64
20	15.20	16.30	18.18	17.44

SPECIFICATIONS

- 1.Current rating : 1.0A AC , DC
  - 2.Voltage rating : 50V AC , DC
  - 3.Temperature rating : -25°C ~ +85°C
  - 4.Insulation resistance : 100MΩ min.
  - 5.Withstand voltage : 250V AC / minute
  - 6.Contact resistance : 20mΩ /Max
- Material:
- 1.Housing : LCP, UL94V-0
  - 2.Contact : Brass, Gold Plated over all Nickel
  - 3.Fitting Nail : Brass, Gold Plated over all Nickel



TOLERANCE UNLESS OTHERWISE STATED :  
 Up to 5 ±0.2  
 Above 5 ~ 15 ±0.3  
 Above 15 ~ 30 ±0.4  
 Above 30 ~ 50 ±0.5  
 Angle ±0.3

3RD. ANGEL'S

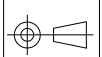

UNITS

MM

DRAWN BY:	DATE	MAT'L	TITLE	CONNECTOR
Jack Lu	06/12/24	FINISH	MODLE	WAFER 0.8mm . SMT 90度
CHECKED BY:	DATE	SCALE	DWG NO.	WF-0800RSxx-S304
Jacky Chen	06/12/24	1 : 1	PART NO.	WF-0800RSxx-S304
APPROVED BY:	DATE	SHEET NO.	1 of 1	
Tony Kao	06/12/24			

2	更新Contact鍍層	Jack	061224
1	更新圖面	Jack	092016
ITEM NO.	DESCRIPTION	DRAWN	DATE